

Coarse Wavelength Division Multiplexer – CWDM

> bandsplitter 4 skip 0, splits red CWDM band in 4+4 channels

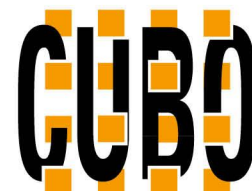

Features

- High isolation bandsplitter for CWDM grid
- Upgrade channel, integrated bandsplitters and tap ports available
- Micro-hybrid construction in a sealed metal housing
- Epoxy-free optical path, ITU G.694.2 and Telecording GR1221 compliant
- Extremely small component dimensions: 19 x 15.5 x 9 mm³, other dimensions on request
- Also available as integrated Patch Cord CWDM for flexible system configurations to enable multiplexing without using any board space
- Single mode and multi mode fibers possible, fiber packaging: loose tube or 250 μm coating
- Packaging on line card or in CWDM sub-system for rack mounting on request

Applications

- Combines / separates 2 bands of the CWDM channel grid
- Metro Core, Metro Access, Metro Enterprise, Cable TV, 3G Telephony (UMTS), Datacomm, WAN, RFTS, Sensor Applications
- Analog and digital transmission systems

Specifications

Parameters	Coarse Wavelength Division Multiplexer – 4 skip 0 (all values refer to single mode)		
Channels	separation / combination of 2 bands		
Center Wavelength [nm]	common: 1471 / 1491 / 1511 / 1531 / 1551 / 1571 / 1591 / 1611 port 1: 1511 / 1531 / 1551 / 1571 or customized port 2: 1471 / 1491 / / 1591 / 1611 or customized		
Optical Bandwidth	> 13 nm		
Insertion Loss *	multiplexer demultiplexer	< 1.3 dB < 1.5 dB	
Link Loss * for mux – demux pair < 2.8 dB			
Isolation **	multiplexer demultiplexer Isolation Spectral Range	> 15 dB > 30 dB 1460-1620 nm	
Return Loss *	> 45 dB (50 dB typ.)		
Directivity (for mux)	> 50 dB		
Polarization Dependent Loss	< 0.2 dB		
Max. optical power	250 mW		
Operating Temperature	0°C to 60°C		
Storage Temperature	-40°C to 85°C (when removed from plastic package)		
Package Dimensions	19 x 15.5 x 9 mm ³		

* With passband, valid over full temperature range and at all states of polarization but without connector losses.

** Valid over full temperature range and at all wavelengths across the channel.

Additional components according to your specifications on request! Please contact Cube Optics for further details.

Our COLOR-Cubes bring color into play.

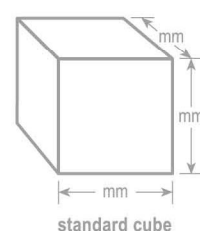
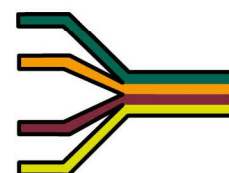

standard cube

All information contained herein is believed to be accurate and is subject to change without notice. No responsibility is assumed for its use. Cube Optics AG, its subsidiaries and affiliates, or manufacturer, reserve the right to make changes without notice, to product design, product components and product manufacturing methods. Some specific combinations of options may not be available. Please contact Cube Optics AG for more information.

Cube Optics AG



Ordering Information

Indicate your requirements by selecting one option from each configuration table. Please write the corresponding codes in the available boxes to form your part number. For more information on this or other products and their availability, please contact Cube Optics AG at +49-6131-69851-0 or via e.mail at sales@cubeoptics.com, or visit our website at www.cubeoptics.com.

Ordering example: C-B4-2-D-A-0-S-11-3-B-15

C - B4 - - - - - - 1 1 - - -

no. of channels	code	mux or demux	code	optional features	code
2 bands	2	mux	M	None	0
		demux	D		

Center wavelengths [nm]	code
1511-1571 & 1471 / 1491 / 1591 / 1611	A

housing	code
Standard BSM	S

Fiber length	code
0.5 m	A
1.0 m	B

Connector in/out	code
none	0
SC/PC	1
FC/PC	2
SC/APC**	3
FC/APC**	4
LC/PC	5
MU/PC	6
E2000	7
E2000/HRL**	8
ST/PC	9

fiber type an packaging	code
Corning SMF-28™ (9,125,250 µm) 900 µm loose tube	1
Corning SMF-28™ (9,125,250 µm) 250 µm coating	2
Multi mode fiber GI (50,125,250 µm) 900 µm loose tube	3*
Multi mode fiber GI (50,125,250 µm) 250µm coating	4*

* Configuration is not reflected by this datasheet.

in/out put if the device is regarded as demultiplexer connectors only available in combination with loose tube fiber protection

** 8° angular polishing

Further configuration on request!

Standard BSM housing

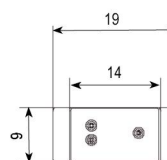
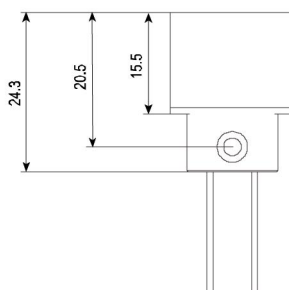
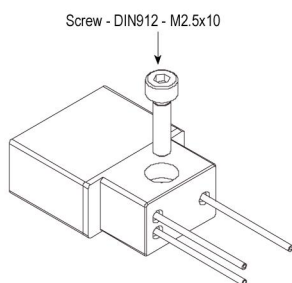

units [mm]