

E-OS 1x2 Optical Switch

Features:

- Wide Wavelength Range
- Low Insertion Loss and low Crosstalk
- High Stability, High Reliability
- Epoxy-free on Optical Path
- Latching and Non-latching types available

Applications:

- System Monitoring
- OADM
- MAN (Metropolitan Area Network)

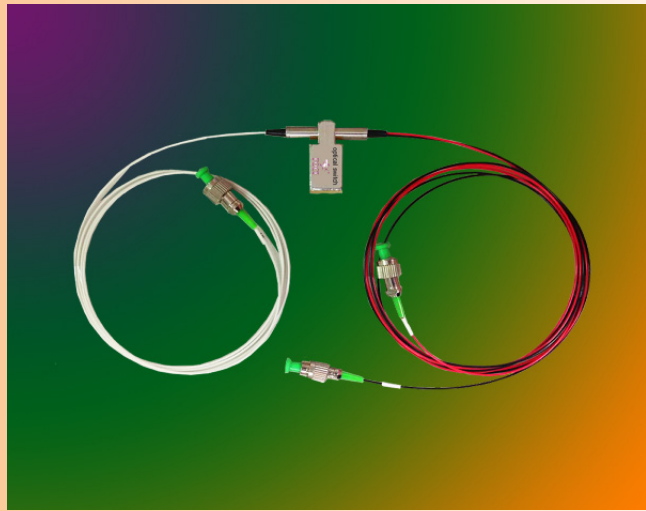

Performance Specifications:

| ITEM | 1x2 Optical Switch | |
|-------------------------------------|----------------------|----------------------|
| | MM | SM |
| Mode type | MM | SM |
| Wavelength Range, nm | 850±40 / 1300±40 | 1260 ~ 1650 |
| Test Wavelength, nm | 850 / 1300 | 1310 / 1550 |
| Insertion Loss, dB ^(1,2) | Typ: 0.8 Max: 1.2 | Typ: 0.6 Max: 0.8 |
| Return Loss, dB ^(1,2) | ≥ 30 | ≥ 50 |
| Crosstalk, dB ⁽¹⁾ | ≥ 35 | ≥ 55 |
| PDL, dB | ≤ 0.05 | |
| WDL, dB | ≤ 0.25 | |
| Repeatability, dB | ≤ ± 0.02 | |
| Operating Voltage, V | 3.0 or 5.0 | |
| Durability, cycles | ≥ 10 Million | |
| Switching Time, ms | ≤ 8 | |
| Optical Power, mw | ≤ 500 | |
| Operating Temperature, °C | -20 ~ +70 | |
| Storage Temperature, °C | -40 ~ +85 | |
| Relative Humidity, % | 5 ~ 95 | |
| Weight, g | 14 | |
| Dimension (LxWxH), nm | 27.0×12.6×8.2 | |

Note: 1 Within operating temperature and SOP.

2 Excluding Connectors.

1x2 Optical Switch

Pin Configurations:

| Type | State | Optical Route | Electric Drive | | | | Status Sensor | | | |
|--------------|-------|---------------|----------------|------|------|-------|---------------|---------|---------|---------|
| | | | Pin 1 | Pin5 | Pin6 | Pin10 | Pin 2-3 | Pin 3-4 | Pin 7-8 | Pin 8-9 |
| Latching | A | P1-P2 | -- | -- | GND | V+ | Close | Open | Open | Close |
| | B | P1-P3 | V+ | GND | -- | -- | Open | Close | Close | Open |
| Non-latching | A | P1-P2 | -- | -- | -- | -- | Close | Open | Open | Close |
| | B | P1-P3 | V+ | -- | -- | -- | Open | Close | Close | Open |

Optical Route:

State A

State B



Dimension:

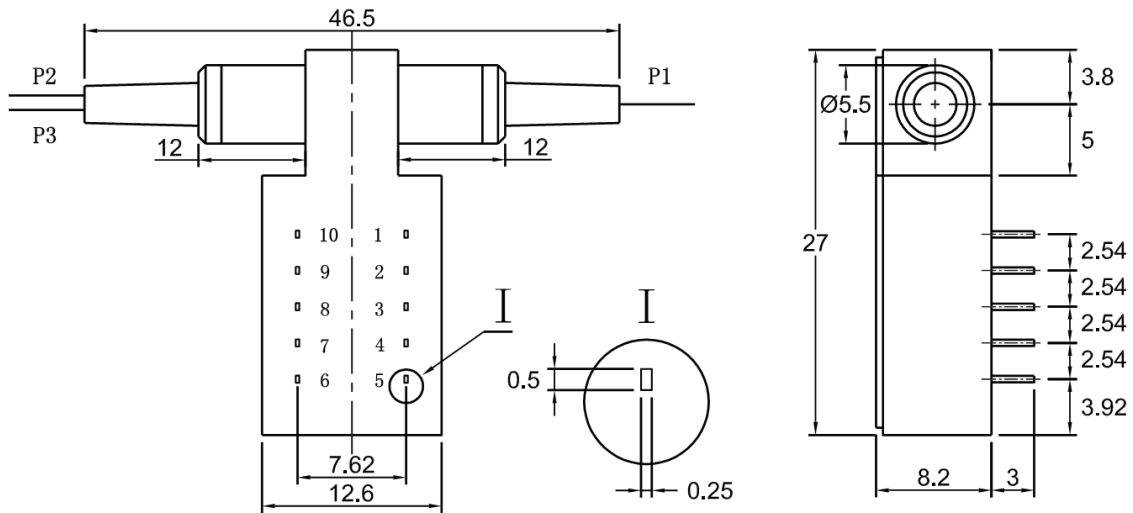

Electrical Specification:

| Specifications | Voltage | Current | Resistance |
|-----------------|-----------|---------|------------|
| 5V latching | 4.5~5.5 V | 36~44mA | 125 Ω |
| 5V non-latching | 4.5~5.5 V | 26~32mA | 175 Ω |
| 3V latching | 2.7~3.3 V | 54~66mA | 50 Ω |
| 3V non-latching | 2.7~3.3 V | 39~47mA | 70 Ω |

1x2 Optical Switch

Ordering Information:

E - OS - - - - - / -

Port No.

- 12 1x2
- 22 2x2

Fiber Type

- S SM
- M MM 50/125
- O MM 62.5/125
- X Others

Cable Type

- C coated fiber
- L 900um loose tube

Wavelength

- 85 850nm
- 13 1310nm
- 15 1550nm
- 35 1310 / 1550nm

Fiber Length

- 10 1 meter
- 20 2 meter
- 05 0.5meter

Connector Type (Input / Output)

- AP angled PC
- AS angled SC
- FC FC type
- SC SC type
- NC No
- LC LC type

Control type

- L Latch type
- N Non-latch type

Operating Voltage

- 1 3.0V
- 2 5.0V